



## Introduction

Since the first Revel® speakers in 1996, Revel products have stood at the forefront of loudspeaker design and performance. To assist in delivering a consistent and repeatable sound signature we have created these backboxes for use with the Revel PerformaBe Architectural loudspeakers. For more information on the set-up and operation of this product refer to the specific loudspeaker's product page on the [revelspeakers.com](http://revelspeakers.com) website. Should further assistance be required feel free to contact customer support at the numbers below:

Inside the US and Canada: +1 888.691.4171

Outside the US and Canada: +44 1707 668 012

## Supported Products & Carton Contents

This document supports the following backbox products:

In-Wall	Installation Guide	Mounting Bar	Wallboard Template / Backbox Cover	Connector Wire	Mounting Screw	Rubber Bushing	Metal Washer	Baffle Gasket Strips
<b>W228BeBB</b> 55.1" x 14.0" x 3.5" (1400mm x 355mm x 87.9mm) H x W x D	<b>1x</b> (This Document)	<b>2x</b> (Pre-attached)	<b>1x</b> 35.3" x 12.2" x 0.3" (896mm x 309mm x 7.6mm) H x W x D	<b>1x</b> 2 Conductor / 14-Gauge Red/Black wire, length 7.9" (200mm), with quick-connect terminal receptacle on one end and 0.3" (8mm) stripped and tinned wire on other.	<b>12x Screws</b> 0.2" (M5) x 3.5" (90mm)	<b>12x Bushings</b> 0.75" OD (19mm) x 0.24" ID (5.84mm) x 1.6" (40mm)	<b>12x Washers</b> 0.5" OD (12.7mm) x 0.2" ID (5.6mm) x 0.05" (1.2mm)	<b>4x Foam Strips</b> 2x - 36.6" (930.5mm) x 1.4" (35.5mm) x 0.4" (10mm) 2x - 11.1" (282mm) x 1.3" (32mm) x 0.4" (10mm)

If you suspect that there has been shipping damage or if you are missing any of the referenced above contents for your model, report it immediately to your dealer or contact our Customer Support at the telephone numbers referenced in the opening of this document.

**NOTE:** This document covers the installation of the W228BeBB backbox only. Refer to the Revel PerformaBe Speaker QSG for details on installing the W228Be loudspeaker after the backbox installation.

## IMPORTANT! Safety Information

**IMPORTANT!** HARMAN International assumes no responsibility for improper installation of hardware or for any personal injuries or product damages resulting from improper installation or a fallen loudspeaker. Read through this document and other documents associated with this product in their entirety and heed all warning before proceeding with the installation of these product(s).

## Backbox Overview

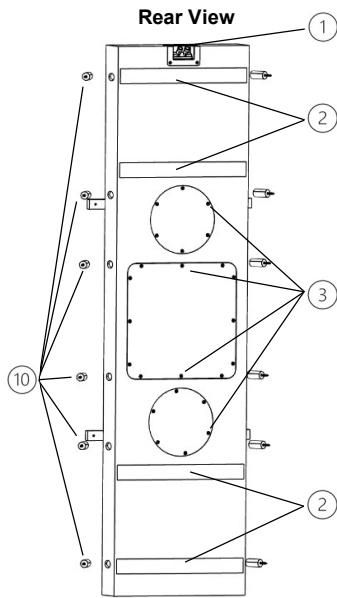

1. Terminal Cup
2. Foam Anti-Vibration Pads – Do Not Remove
3. Backing Plate Screws – Do Not Remove
4. Signal Wires with Quick Connect to Speaker Terminal
5. Signal Wires with Quick Connect from Terminal Cup
6. Temporary Mounting Bars
7. Primary Mounting Holes
8. Baffle Gasket Strips - Four (4) straight gasket pieces
9. Wallboard Template / Backbox Cover
10. Mounting Screw + Washer + Rubber Bushings

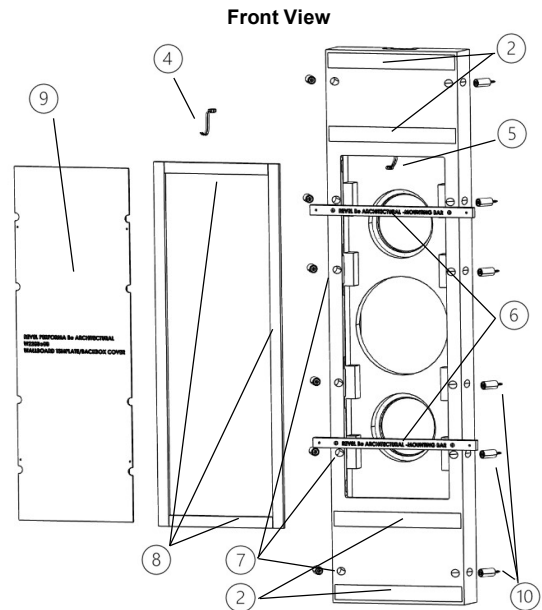

## Backbox Installation

### IMPORTANT:

- The in-wall backboxes are designed to fit a minimum 2x4 framing construction and the in-ceiling backbox is designed to fit a minimum 2x6 framing construction.
- Minimum wallboard thickness supported: 0.4-inch (10mm). Maximum wallboard thickness supported: 0.6-inch (16mm).
- Some of these backboxes are heavy and large. Installation will go more smoothly and safely with two people. We strongly suggest enlisting the aid of a helper when installing these products.
- When positioning the backbox, be aware that the wiring terminal cup is the “top of the backbox” when inserting the speaker panel, this will assure adequate length of speaker connection wire inside the backbox.
- These backboxes were designed to be mounted in standard 16-inch on center wood framed construction (wall or ceiling). Any different on-center framing measurement will require special consideration by the installer.

- We are referencing the installation instructions for a vertical in-wall orientation, but these backboxes can be installed vertically or horizontally. Due to the height / length of some of these backboxes, when mounting horizontally multiple vertical framing studs may have to be cut. We advise consulting a general contractor to determine the appropriate header build-out that will need to be done to properly support the changes in the framing.

## Installation Steps:

- For existing construction, carefully remove a section of wallboard that reveals the framing studs on either side of the bay where the backbox will be installed and long enough to allow the backbox to be inserted into the opening.
  - Attach the speaker wire leads from the amplifier to the appropriate terminal cup inputs. It is important to connect all speakers appropriately: (+) on the speaker / backbox to (+) on the amplifier and (-) on the speaker / backbox to (-) on the amplifier. Wiring any one speaker "out of phase" (+ to - and - to +) to other speakers in the system will result in thin sound, weak bass, and poor imaging.
  - Carefully lift and fit the backbox into position between the framing studs and run a screw (not supplied) through the end of each mounting bar and into the framing stud. This will temporarily hold the backbox in place while completing the installation.
  - Insert a rubber bushing into each primary mounting hole, then place a flat washer on top of the rubber bushing and push the supplied 3.5-inch (90mm) screw through the washer, rubber bushing, and then screw it securely into the framing stud. Tighten the screws enough to expand the rubber bushings, but do not overtighten. Repeat for each of the primary mounting holes.
  - Make sure the back box is securely attached to the framing studs and then remove the mounting bars completely. Discard.
  - Remove the Wallboard Template / Backbox Cover board.
  - Attach the four (4) baffle gasket strips to the area around the opening in the backbox where the speaker will be attached.
  - We now advise testing your wiring to make sure you have correct speaker wire connections prior to the next step.
  - Re-attach the Wallboard Template / Backbox Cover board to the backbox using original screws. (The board will partially cover the baffle gasket strips that were applied in Step 7.)
  - The area is now ready for wallboard installation / finishing. The wallboard installer should apply wallboard to the outside edges of the Wallboard Template / Backbox Cover attached to the backbox (Covering the baffle gasket excess material). Do not wallboard over the Wallboard Template / Backbox Cover.
- NOTE:** Wallboard thickness range:  
 Minimum thickness of 0.4-inch (10mm)  
 Maximum thickness of 0.6-inch (16mm)
- When ready to install the speaker, remove Wallboard Template / Backbox Cover to expose backbox opening / install speaker.

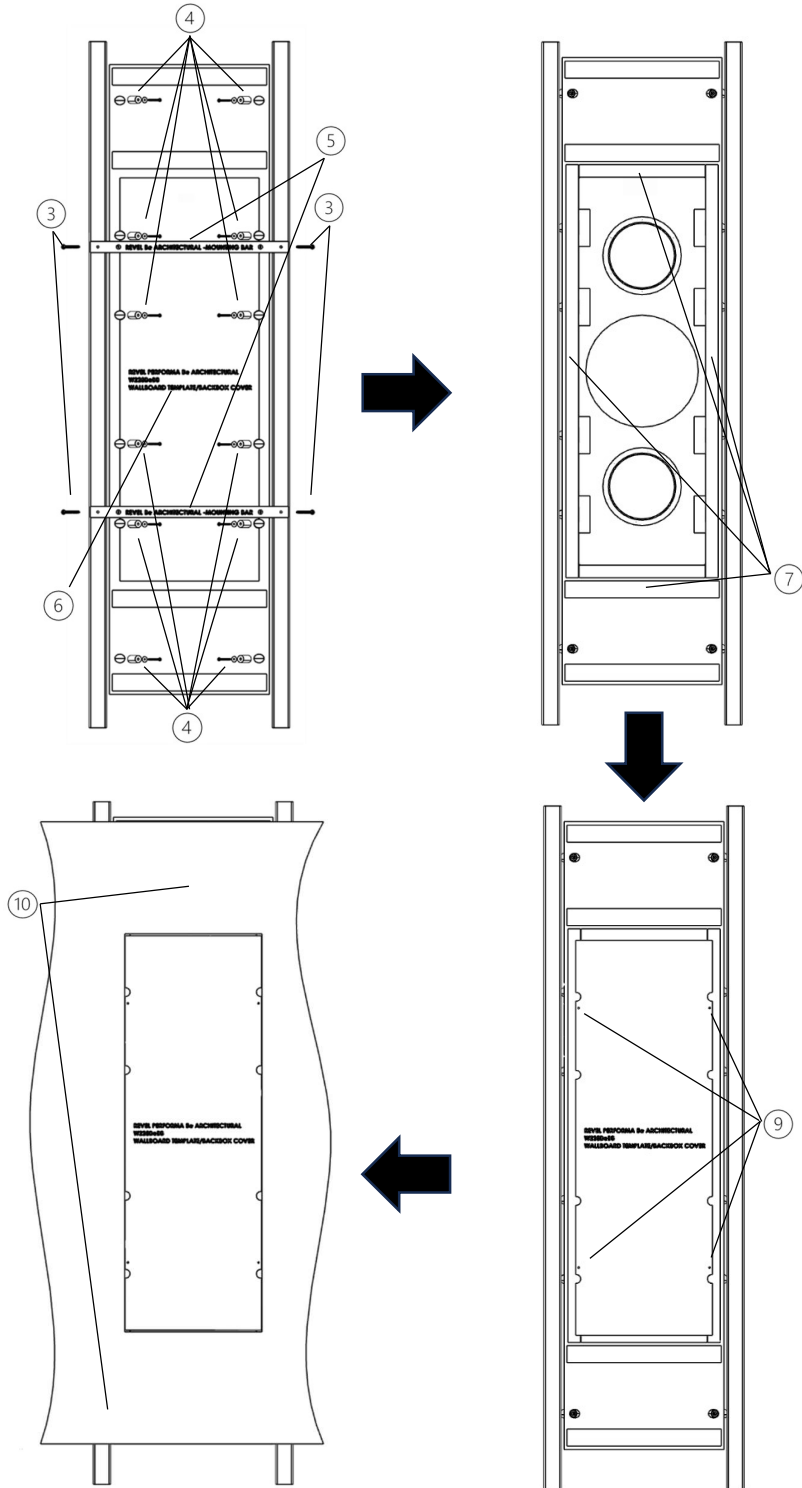

Harman International Industries, Incorporated.  
 8500 Balboa Blvd, Northridge CA 91329 United States.



**European Representative:** Harman International Industries, Incorporated.  
 EMEA Liaison Office, Danzigerkade 16G, 1013 AP Amsterdam, The Netherlands.

**UK Business Address:** Ground Floor, Westside 2, London Road, Apsley, Hemel Hempstead, Hertfordshire, HP3 9TD, United Kingdom.

© 2023 Harman International Industries, Incorporated. All Rights Reserved.

Revel is a trademark of Harman International Industries, Incorporated registered in the United States and other countries.

